

# Burns Supper & Ball

## January 27, 2024

### Music: Andy Imbrie and Caroline McCaskey

**Torrance Woman's Club**  
1422 Engracia Ave., Torrance

**Theme: Robert Burns song "Rantin' Rovin' Robin"**



1828 posthumous portrait of Robert Burns  
by Alexander Nasmyth

Program		
Alan J. Smith	B J	Book 45
Rovin' Robin	I R	Scottish Dance Archives
Bonnie Stronshiray	A S	Glasgow Assembly SCDs
The Scallywag	I J	Book 52
Flowers of Edinburgh	B R	Book 1
The Aviator	I J	Book 52
Miss Jane Muirhead/Dunsmuir	B S	Dunsmuir Dances
Forty and Counting	A R	Book 52
Monymusk	B S	Book 11
Burns Night	B J	Boston 50th Anniversary
The Magic of Merrill	I R	S.F. Branch Dances Online
Scott Meikle	I R	Book 46
Glasgow Lasses	B S	Book 34
Best Set in the Hall	A J	Book 46
A Summer Meeting	I S	Book 48
The Deil amang the Tailors	B R	Book 14

**Doors open 4:30 p.m.**  
**Supper 5:00 p.m.**  
**Grand March 6:15 p.m.**  
**Dance 6:30 p.m.**

**Dancers: \$80**  
**Nondancers: \$70**  
**No payment at the door**  
**~ Silent Auction ~**

Please mail reservation with a check payable to RSCDS Los Angeles. Reservations must be received, not postmarked, by Jan. 13.

Mail to Robb Quint, 325 Lynn Oaks Court, Thousand Oaks, CA 91320-4760 (805-498-2303 or volleyballjerry@aol.com)

DANCER @ \$80 \_\_\_\_\_ NONDANCER @ \$70 \_\_\_\_\_ Total \_\_\_\_\_

Entree choices: Roast Beef ~ Grilled Chicken with Lemon ~ Vegetarian

NAME \_\_\_\_\_ ENTREE \_\_\_\_\_

NAME \_\_\_\_\_ ENTREE \_\_\_\_\_

EMAIL \_\_\_\_\_

**DIRECTIONS**

**to Torrance Woman's Club:**

**From the north:**

Take 405 Freeway and exit at Crenshaw Blvd. (39)  
Turn right onto Crenshaw.  
Turn left onto Torrance Blvd.  
Turn right onto Arlington Ave.  
Then slight right to Engracia Ave.  
1422 Engracia is on the left.

**From the south:**

Take 405 Freeway and exit at Western Ave. (38B)  
Turn left onto Western Ave.  
Turn right onto Torrance Blvd.  
Turn left onto Arlington Ave.  
Then slight right onto Engracia Ave.  
1422 Engracia is on the left.

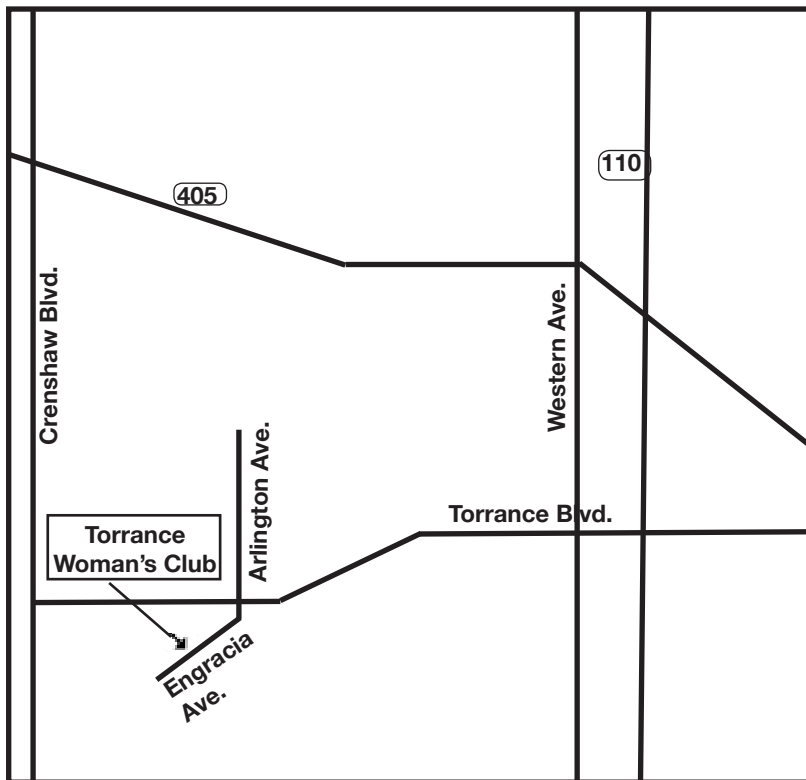

**Street parking only**

The doors will not open until 4:30 p.m., due to the rules of the venue. If you arrive early, please wait in your car.

**Websites:**

- <http://www.rscds-losangeles.org/>
- <http://www.rscds-oc.org/>
- <http://www.rscds-sgvb.org/>

